

Construction of the RD MASTERJET

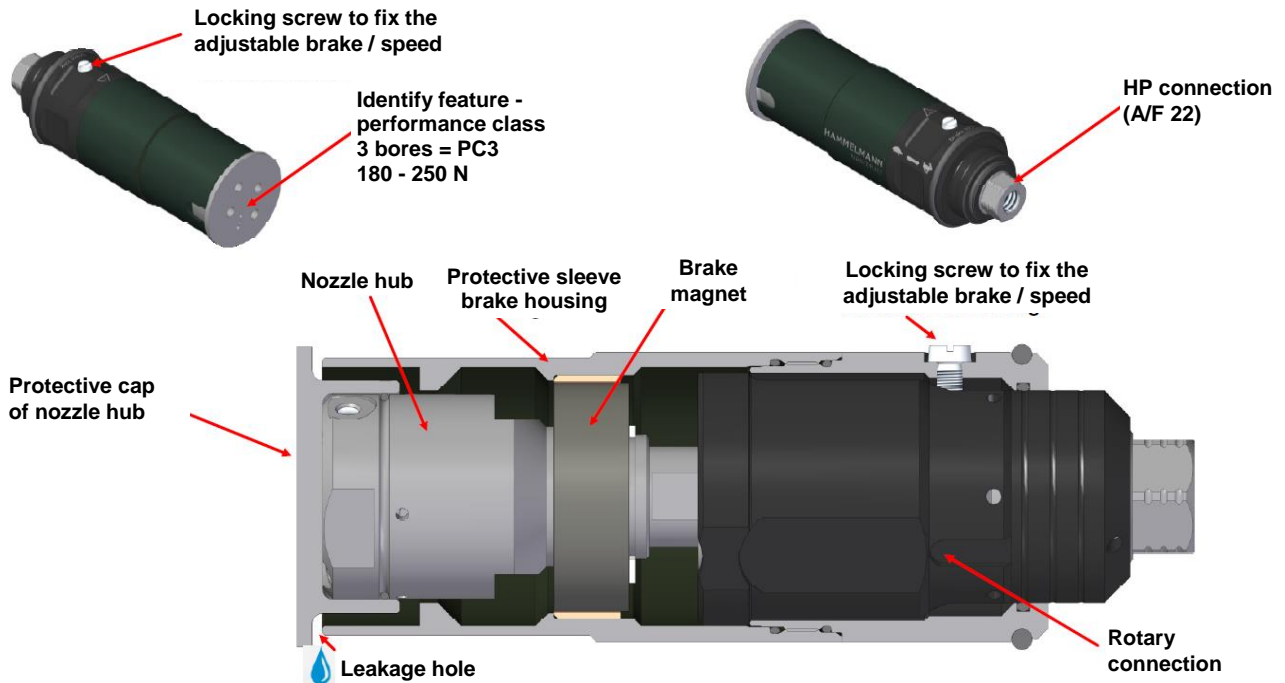

Connection threads

Metric

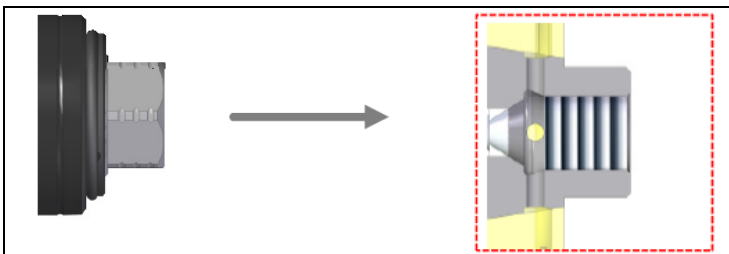

HP connection: M 14 x 1.5 LH

American (imperial)

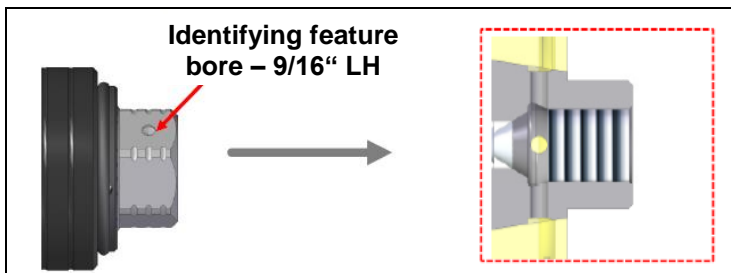

HP connection: 9/16" UNF LH

Brake adjustment

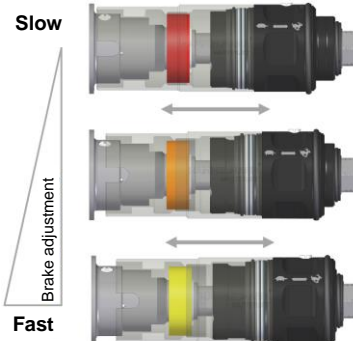

Differences 1800 and 3200 HPS

▪ Masterjet 1800

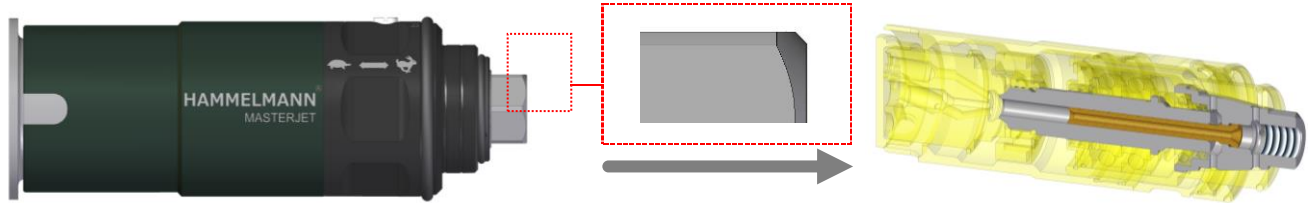

Operating pressure: max. 1800 bar

Identifying feature

▪ Masterjet 3200

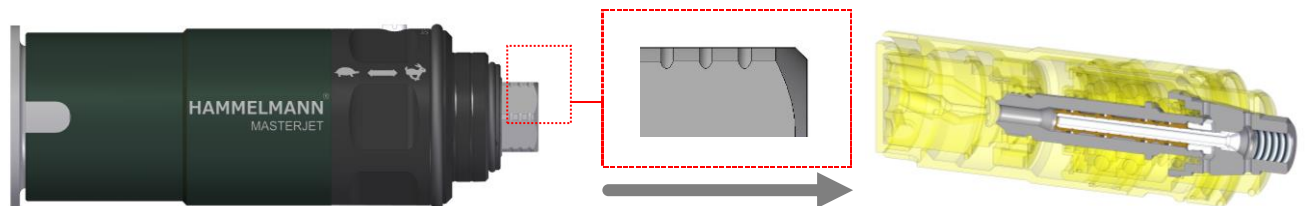

Operating pressure: max. 3200 bar

Identifying feature

RD MASTERJETS PC1

4 NOZZLE DESIGN

13.A.11 – 11/19

RD MASTERJETS – Performance class **PC1**

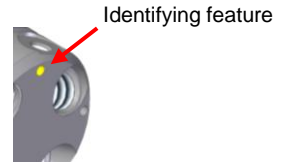

	RD MASTERJET 1800 PC1		RD MASTERJET 3200 HPS PC1	
	Code no.	Code no.	Code no.	Code no.
	00.00786.0310	00.00786.0311	00.00786.0300	00.00786.0301
HP connection:	M 14 x 1.5 LH	9/16" – 18 UNF LH	M 14 x 1.5 LH	9/16" – 18 UNF LH
	(60° metallic seal cone)		(60° metallic seal cone)	
Operating pressure:	max. 1800 bar		max. 3200 bar	
	min. 100 bar		min. 500 bar	
Flow rate:	max. 60 l/min		max. 50 l/min	
Leakage:	approx. 0.3 - 1.2 l/min (when new) depending on the operating pressure (max. 2.5 l/min during operation)		approx. 0.2 - 0.6 l/min	
Length:	176 mm		176 mm	
Diameter:	58 mm		58 mm	
Brake:	adjustable magnetic brake (variable speed)		adjustable magnetic brake (variable speed)	
Sealing:	Labyrinth - 1800 bar – i/d 3.5 mm		HPS - 3200 bar - i/d 3.2 mm (industrial design)	
Reaction forces:	90 - 130 N → PC1 [see nozzle table]		90 - 130 N → PC1 [see nozzle table]	
Rotation speed:	approx. 800 - 2500 min ⁻¹ at 90 N reaction force approx. 1000 - 3500 min ⁻¹ at 130 N reaction force		3-stage adjustable via eddy current brake	
Nozzle hub:	4/2 nozzles (2 or 4 nozzles design P/T)		4/2 nozzles (2 or 4 nozzles design P/T)	
Nozzle inserts:	Nozzle design "P" (sapphire), max. 1800 bar Nozzle design "T" (diamond), max. 1800 bar Thread M10 (not part of the assembly)		Nozzle design "P" (sapphire), max. 3000 bar Nozzle design "T" (diamond), max. 3200 bar Thread M10 (not part of the assembly)	
Plug:	01.05214.0045 (not part of the assembly)		01.05214.0045 (not part of the assembly)	
Protective cap:	01.01894.0062		01.01894.0062	
Spare parts kit:	00.05617.0031		00.05617.0030	
Adapter for SP 1000:	01.05320.0256 max. 1000 bar, 3/8"	---	01.05320.0256 max. 1000 bar, 3/8"	---
Weight:	1.0 kg (without protective cap pos. 110)			
Total weight:	1.2 kg			

HAMMELMANN®

RD MASTERJETS PC1

4 NOZZLE DESIGN

Nozzle table

RD MASTERJETS PC1 - 1800 bar

Pressure	2 nozzles design "P"	Flow rate	Reaction force
1800	2 x 0.60 mm	15 l/min	130 N
1500	2 x 0.65 mm	16 l/min	130 N
1000	2 x 0.80 mm	20 l/min	130 N
500	2 x 1.10 mm	26 l/min	120 N

1800 bar
Identifying feature
[even key flat]

Pressure	4 nozzles design "P"	Flow rate	Reaction force
1800	4 x 0.40 mm	14 l/min	120 N
1500	4 x 0.45 mm	16 l/min	120 N
1000	4 x 0.55 mm	19 l/min	120 N
500	4 x 0.80 mm	28 l/min	130 N

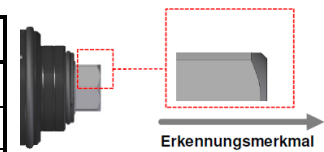

RD MASTERJETS PC1 - 3200 bar

Pressure	2 nozzles design "P"	Flow rate	Reaction force
3000	2 x 0.45 mm	12 l/min	120 N
2500	2 x 0.50 mm	13 l/min	125 N
2000	2 x 0.55 mm	14 l/min	120 N
1500	2 x 0.65 mm	16 l/min	125 N

3200 bar
Identifying feature HPS
[3 grooves at key flat]

Pressure	4 nozzles design "P"	Flow rate	Reaction force
3000	2 x 0.35 mm	12 l/min	125 N
	2 x 0.40 mm		
2500	4 x 0.35 mm	13 l/min	120 N
2000	4 x 0.40 mm	14 l/min	125 N
1500	4 x 0.45 mm	16 l/min	120 N

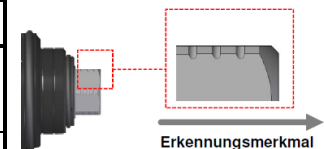

If the nozzle inserts chosen are not suitable and cause a too high rotational speed of the nozzle hub, the rotorjet may suffer irreparable damage.